

DIN 929

Hexagon weld nuts

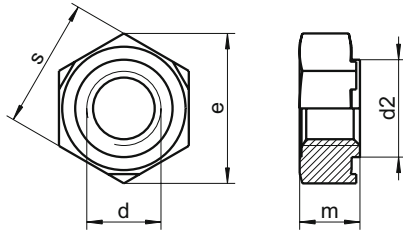

d	m	s	e	d2	⌀
M3	3,0	7,5	8,15	4,5	7,5
M4	3,5	9	9,83	6,0	9
M5	4,0	10	10,95	7,0	10
M6	5,0	11	12,02	8,0	11
M8	6,5	14	15,38	10,5	14
M10	8,0	17	18,74	12,5	17
M12	10,0	19	20,91	14,8	19
M16	13,0	24	26,51	18,8	24

Grade	SU
▲ ●	200
▲ ●	200
▲ ●	200
▲ ●	200
▲ ●	200
▲ ●	100
▲ ●	50
▲ ●	50

■ A1 / ▲ A2 / ● A4 | SU: Sales unit | All measurements in mm | Other dimensions on request.

Example item no. 929-2-8 DIN 929 - A2 - M8

Please note that hexagon weld nuts DIN 929 up to M8 will be delivered with three weld cams and starting from M10 with weldcings rings. Square weld nuts can be found as DIN 928 on the previous page. Weld nuts with welding nipples, type A can be found as WS 9320, with welding nipples type B can be found as WS 9323 and with plain type C can be found as WS 9326 in this catalogue.