

HEXAGON SOCKET COUNTERSUNK SCREW



DATASHEET
ISO 10642 SIM. DIN 7991

ISO 10642 SIM. DIN 7991

TECHNICAL SPECIFICATIONS

ISO 10642 replaces DIN 7991. There is limited interchangeability of the individual dimensions. Head height and head diameter have been partially changed. Nominal diameters M18, M22 and M24 are removed.

Material	Stainless steel
Quality	A2 / A4
Property class	050 / 070 / 080
Surface	Blank
Product class	A
Tolerances	ISO 4759-1
Mechanical properties	ISO 3506-1
Measurement letters and notations	ISO 225
Thread tolerance class	6g
Thread according to	ISO 965-1
General requirements	ISO 8992

Starting from a thread diameter of M5 and length $< 2,5 d$ our countersunk screws are stamped according to DIN3506-1.

1. Manufacturer's ID
2. Material
3. Property class

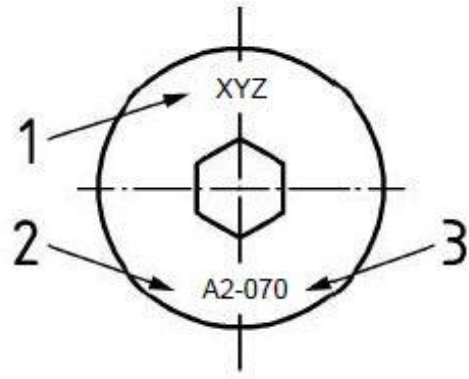
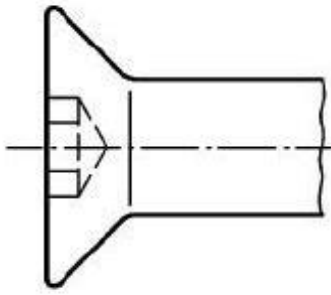

DIMENSIONS (MM)

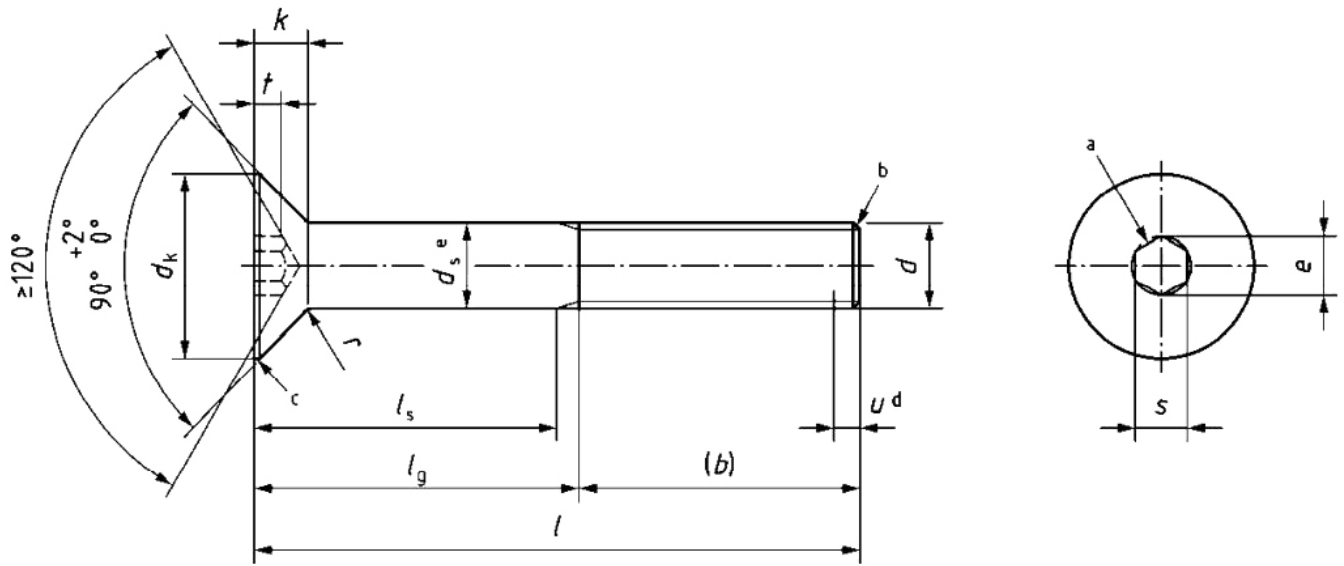

Thread d	M2	M2,5	M3	M4	M5	M6	M8	M10	M12	(M14)	M16	M20	
p^a	0,4	0,45	0,5	0,7	0,8	1	1,25	1,5	1,75	2	2	2,5	
b^b	ref.	-	18	20	22	24	28	32	36	42	48	60	
d_k	In fact min.	3,70	4,80	5,54	7,53	9,43	11,34	15,24	19,22	23,12	26,52	29,01	35,40
	In fact max.	4,09	5,08	5,81	7,96	10,07	12,16	16,43	20,69	24,81	28,31	30,61	36,75
d_a	max.	2,36	2,74	3,30	4,40	5,50	6,60	8,54	10,62	13,50	15,50	17,50	22,00
d_s	max.	2,00	2,50	3,00	4,00	5,00	6,00	8,00	10,00	12,00	14,00	16,00	20,00
	min.	1,86	2,36	2,86	3,82	4,82	5,82	7,78	9,78	11,73	13,73	15,73	19,67
k	max.	1,35	1,69	1,86	2,48	3,10	3,72	4,96	6,20	7,44	8,40	8,80	10,16
	min.	1,13	1,41	1,52	2,12	2,67	3,22	4,37	5,56	6,71	7,59	7,87	9,04
r	min.	0,1	0,1	0,1	0,2	0,20	0,25	0,4	0,4	0,6	0,6	0,8	
$e^{c,d}$	min.	1,454	1,733	2,303	2,873	3,443	4,583	5,723	6,863	9,149	11,429	13,716	
t	max.	0,85	1,15	1,25	1,65	2,00	2,50	3,20	3,90	4,90	5,10	6,40	
	min.	0,75	1,00	1,10	1,40	1,75	2,20	2,90	3,50	4,30	4,50	5,60	
s^d	nom.	1,3	1,5	2	2,5	3	4	5	6	8	10	12	
	max.	1,360	1,560	2,080	2,580	3,080	4,095	5,140	6,140	8,175	10,175	12,212	

	min.	1,320	1,520	2,020	2,520	3,020	4,020	5,020	6,020	8,025	10,025	10,025	12,032
--	------	-------	-------	-------	-------	-------	-------	-------	-------	-------	--------	--------	--------

DIMENSIONS (MM)

Length l		M2		M2,5		M3		M4		M5		M6		
No- minal size	min.	max.	l _s min.	l _g max.	l _s min.	l _g max.	l _s min.	l _g max.	l _s min.	l _g max.	l _s min.	l _g max.	l _s min.	l _g max.
	5	4,76	5,24											
6	5,76	6,24												
8	7,71	8,29												
10	9,71	10,29												
12	11,65	12,35												
16	15,65	16,35					Full thread							
20	19,58	20,42												
25	24,58	25,42												
30	29,58	30,42					9,5	12	6,5	10				
35	34,50	35,50							11,5	15	9	13		
40	39,50	40,50							16,5	20	14	18	11	16
45	44,50	45,50									29	23	16	21
50	49,50	50,50									24	28	21	26
(55)	54,40	55,60			Lengths to be defined between buyer and manufacturer								26	31
60	59,40	60,60											31	36
(65)	64,40	65,60												
70	69,40	70,60												
80	79,40	80,60												
90	89,30	90,70												
100	99,30	100,7												
110	109,3	110,7												

Length dimensions for the diameters M8-M20 can be found on the next page.

